

# ASM-50 ZAM

# ASM-130 ZAM

# ASM-150 ZAM

# ASM-175 ZAM

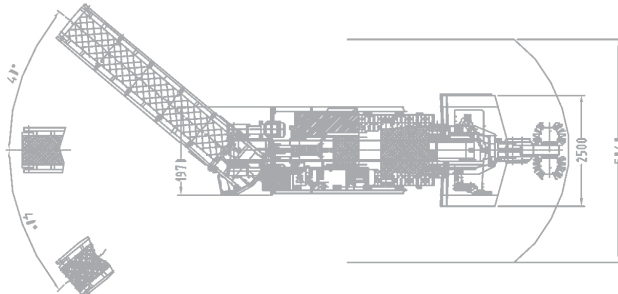
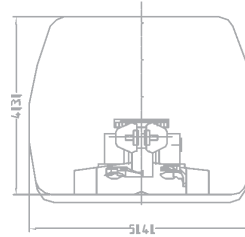
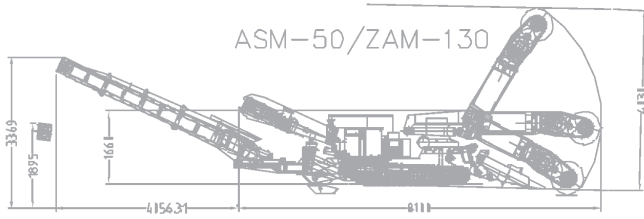

Gewicht: .....28 t  
 Schrämmotorleistung: .....132 kW  
 Max. Profil: .....19,2 m/2

Weight: .....28 t  
 Cutterhead Power: .....132 kW  
 Max. Profile: .....19,2 m/2

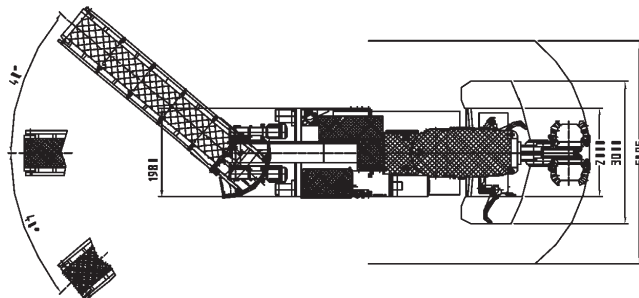
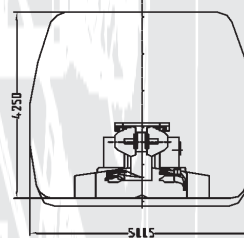
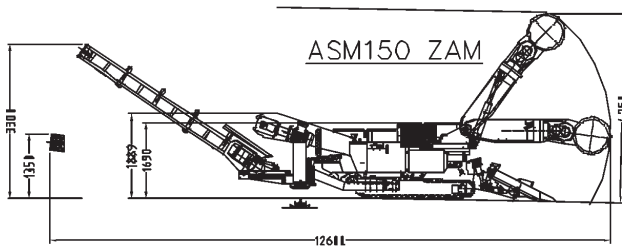

Gewicht: .....33 t  
 Schrämmotorleistung: .....150 kW  
 Max. Profil: .....21 m/2

Weight: .....33 t  
 Cutterhead Power: .....150 kW  
 Max. Profile: .....21 m/2

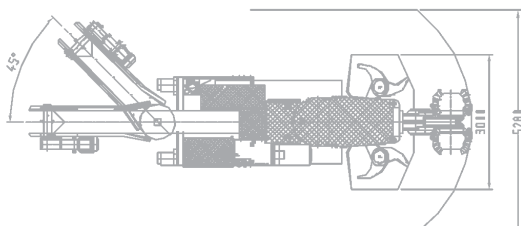
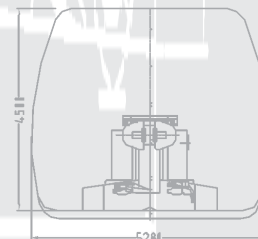
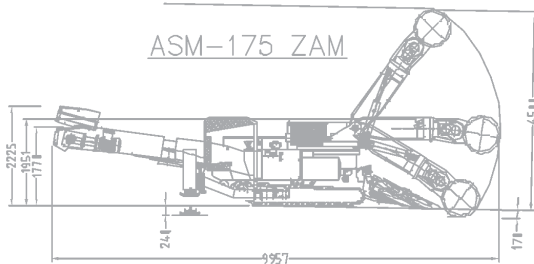

Gewicht: .....37 t  
 Schrämmotorleistung: .....175 kW  
 Max. Profil: .....22,5 m/2

Weight: .....37 t  
 Cutterhead Power: .....175 kW  
 Max. Profile: .....22,5 m/2



# Technical Specification

## ASM-50/ZAM 130    ASM-150 ZAM    ASM-175 ZAM

<b>Machine weight</b>	29 t	34 t	37t
<b>Machine dimensions:</b>			
- Length	7,9 m	8,1 m	10,3 m
- Loading apron width (min,max)	2,0-3 m	2,0-3,8 m	2,5-3,8 m
- Machine width	1,8 m	2,0 m	2,0 m
- Machine height/ground clearance	1,66/0,24 m	1,77/0,24 m	1,9/0,24 m
-Ground pressure	12,8 N/cm <sup>2</sup>	13,5 N/cm <sup>2</sup>	14,2 N/cm <sup>2</sup>
<b>Capacities and speeds:</b>			
Installed motor capacities (50 Hz)			
- Total	184 kW	227 kW	265 kW
- Cutter motor	132 kW	150 kW	175 kW
- Crawler motor (hydr.)	2 x 18 kW	2 x 24 kW	2 x 24 kW
- Chain conveyor and loading motor	2 x 15 kW	2 x 22 kW	1x 15 kW
- Motor for Hydraulic	22 kW	45 kW	75 kW
- Swivel tail conveyor motor(optional)	11 kW	11 kW	
<b>Speeds at 50 cycles</b>			
- Tramming speed	5 m/min	5 m/min	5 m/min
- Chain conveyor speed	0,9 1,3 1,5 m/min	0,9 1,3 1,5 m/min	0,9 1,3 1,5 m/min
- Swivel tail conveyor speed	1,8 m/sec	1,8 m/sec	
- Cutter head speed	2,9 3,5 m/sec	2,9 3,5 m/sec	3,1 3,7 m/sec
- Operating pressure-hydraulics	220/315 bar	220/315 bar	220/315 bar
<b>Electrical system</b>			
- Explosion proof equipment	400 / 500 / 1000 V	400 / 500 / 1000 V	400 / 500 / 1000 V
- Non explosion proof equipment	400 / 1000 V	400 / 1000 V	
- Transformer size	315 kVA	450 kVA	600 kVA
<b>Operating data</b>			
<b>Cutting profiles</b>			
- Max.height standard design	4,13 m	4,25 m	4,5m
- Max.height with elevation	4,40 m	4,50 m	4,7 m
- Max.cutting width	5,05 m	5,05 m	5,25 / 5,6 m
- Max.profile standard	19,2 m <sup>2</sup>	20,5 m <sup>2</sup>	21,5 m <sup>2</sup>
- Max.profile with elevation	21 m <sup>2</sup>	21,5 m <sup>2</sup>	22,5 m <sup>2</sup>
- Cutting below track level	0,1 m	0,1 m	0,17 m
<b>Ability to cut inclinations</b>			
	Up/down	up to 20 gon	
	Cross grade	up to 6 gon	
<b>Machine componenets</b>			
	<b>Dimensions</b>	<b>Weight</b>	
Largest component (track frame left/right)	3,55 m x 0,95 m x 0,95 m	4000 kg	
Heaviest component (turret cpl.)	1,55 m x 1,2 m x 1,5 m	4200 kg	

### IB-A - Mining Machines & Spare Parts - Maschinen und Einzelteilhandel

Granitzen 90 - A-8742 Obdach ● Tel: 0043 3573 605 01 ● Fax: 0043 3573 605 13

E-mail: [ibatec@aon.at](mailto:ibatec@aon.at) ● <http://www.ibatechno.info>